

162008

REV	REVISION	BY	BCN	DATE
A	INITIAL RELEASE	TT		12/2/08

UNCONTROLLED DRAWING

(DATA SUBJECT TO CHANGE WITHOUT NOTICE)

FOR ADDITIONAL HELP CONTACT ENGINEERING@ADALET.com

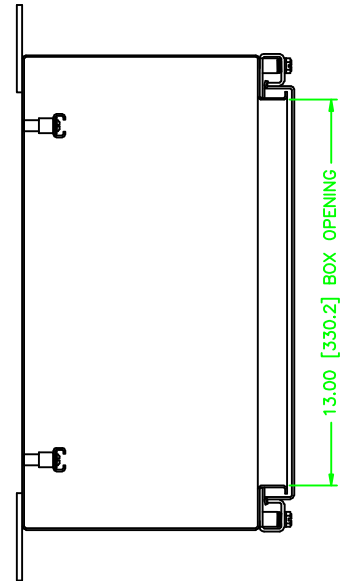
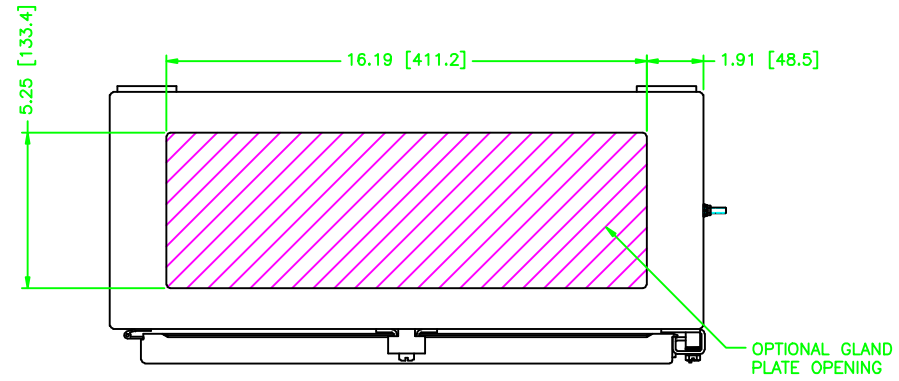

SECTION A-A

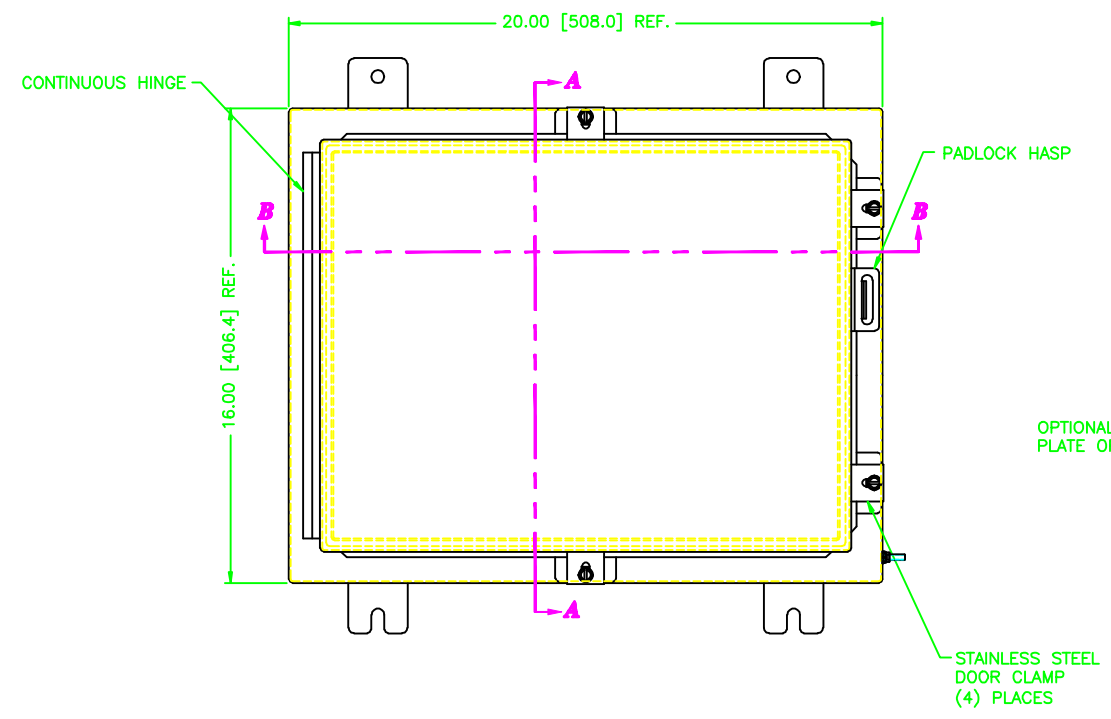

SECTION B-B

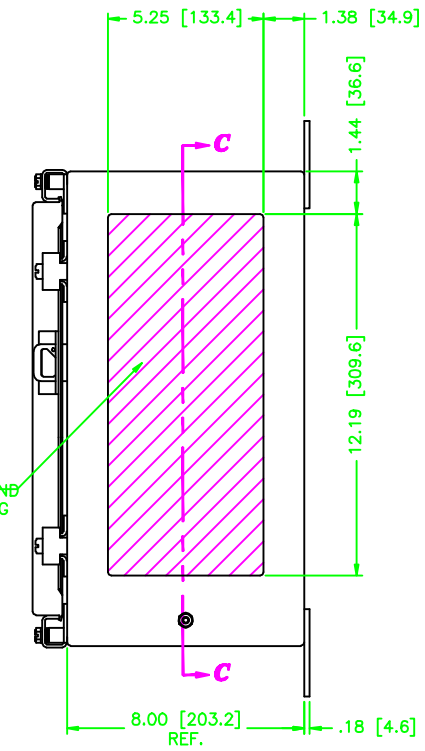

SECTION C-C

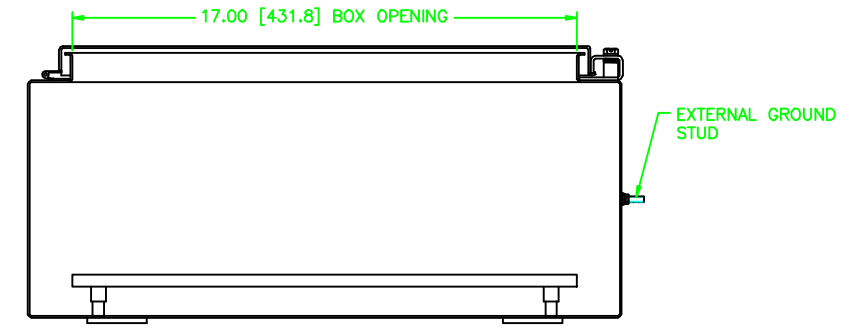
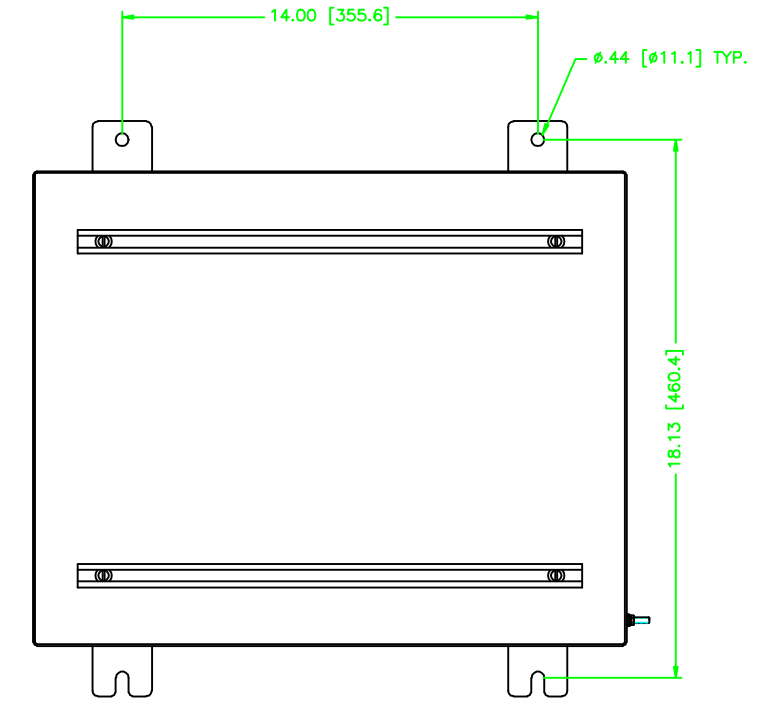

ENCLOSURE MATERIAL	CATALOG NUMBER	PART NUMBER
SS316L	TN4X8-162008U	M11170
SS304	TN4X-162008U	M11104

<p>UNLESS OTHERWISE SPECIFIED DIMENSIONS ARE IN INCHES. SHEET METAL TOLERANCES NOT OTHERWISE SPECIFIED: FINISH: 16 GA JXX ± .02" JXX ± .010" ANGLES ± 0°-30" INSIDE BEND RADIUS = .040" NOM. WARPAGE = 1/16" PER FOOT ALL WELD SIZES ARE MIN.</p>		<p>ADALET A SCOTT FETZER COMPANY Enclosure Systems • Cable Accessories Control Systems</p>		<p>NOTICE TO PERSONS RECEIVING THIS DRAWING: ADALET CLAIMS PROPRIETARY RIGHTS IN THE MATERIALS, METHODS, AND EQUIPMENT DESCRIBED IN THIS DRAWING. THIS DRAWING IS ISSUED IN CONFIDENCE FOR ENGINEERING INFORMATION ONLY AND MAY NOT BE REPRODUCED OR USED TO MANUFACTURE, EITHER WHOLLY OR IN PART, WITHOUT WRITTEN PERMISSION FROM ADALET TO THE USER.</p>	
<p>DATE: 12/2/08 DRAWN BY: TT REV: 1-3 DWG NO: 162008 SHEET: 10F1</p>		<p>TN4-162008 ENCLOSURE ASSEMBLY</p>		<p>DATE: 12/2/08 DRAWN BY: TT REV: 1-3 DWG NO: 162008 SHEET: 10F1</p>	