

Xref I:\BORDERS\DSIZE.DWG

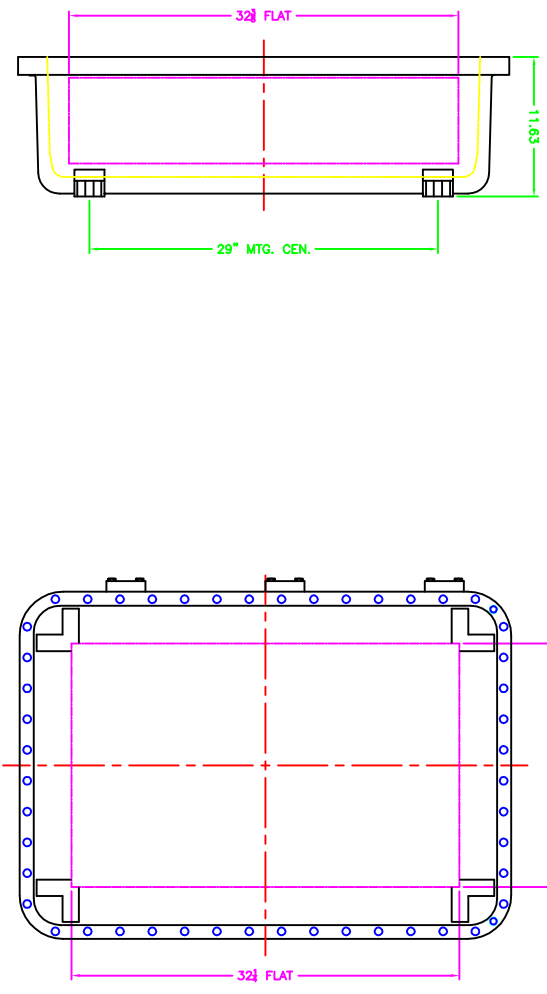
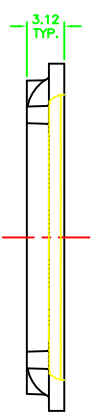
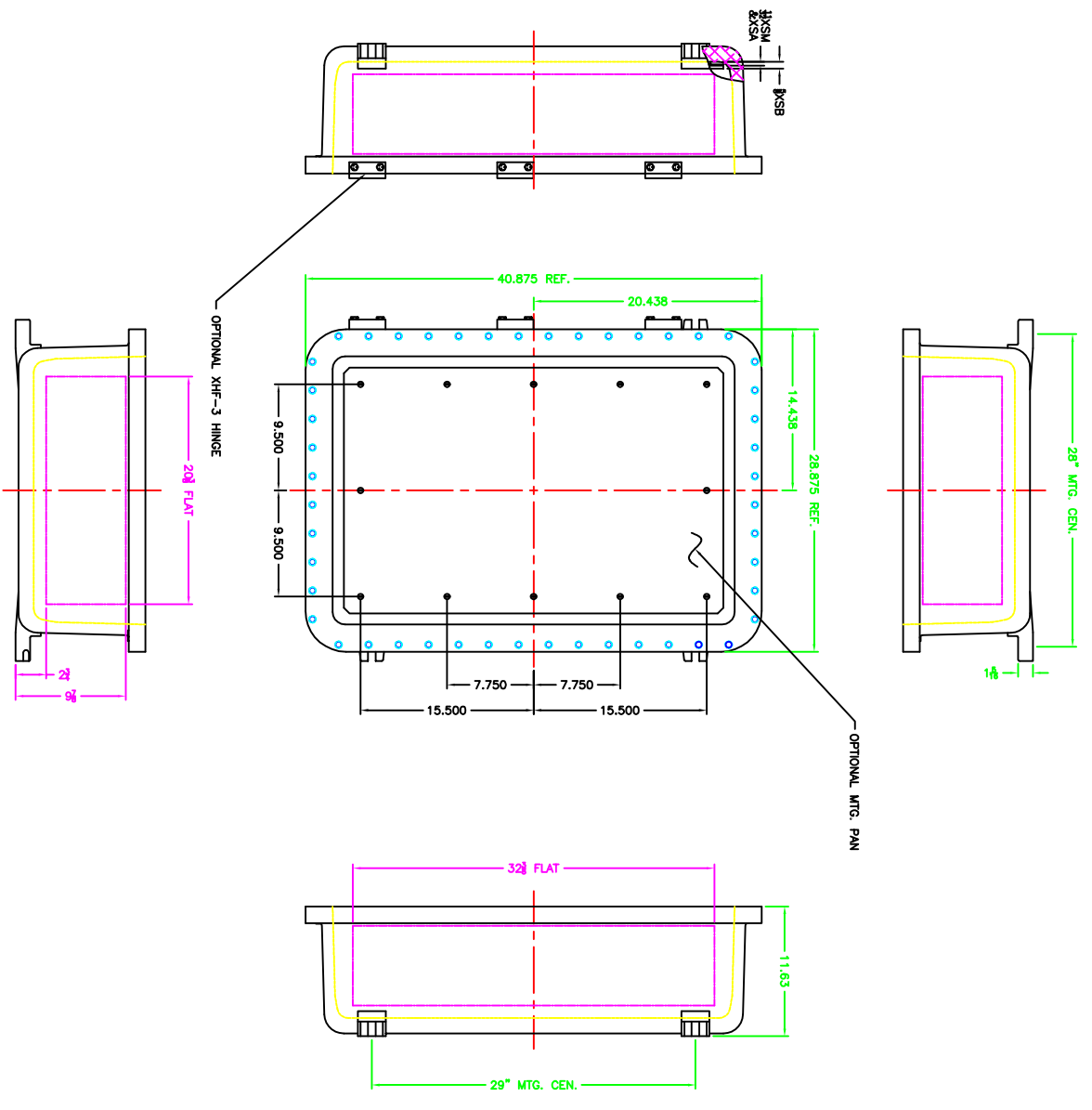

XCE 2436 COVER

- NOTES:
1. MINIMUM SPACING FROM CENTER OF OPERATOR TO NEAREST FLAT IS 1/4"
 2. MINIMUM SPACING BETWEEN #14 NPSM OPERATOR CENTERS IS 3/4" FOR THIS ENCLOSURE.
 3. MAXIMUM NUMBER OF OPERATORS IS 54.
 4. DIMENSION FROM CENTER LINE OF COVER FOR OPERATORS.
 5. DIMENSION FROM CENTER LINE AND BACK OF MFG. LUG FOR CONDUIT.
 6. FOR MFG. ENCLOSURE USE # BOLT.
- COVER DRILLING ALLOWABLE IN XCE ONLY

MODIFIED XCE 243610 ENCLOSURE FOR

DDH

4-15-02
1-9-5
D

SEE NOTES
TIMBLAST
XCE 243610

10F1