

XCE 2436 COVER

OPTIONAL XHF-3 HINGE

EXISTING GRD. SCREW

OPTIONAL MTG. PAM

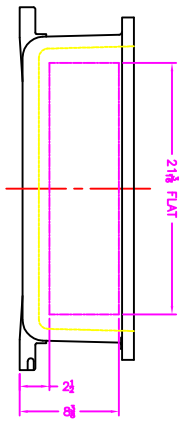

- NOTES:
- COVER BRILLING ALLOWABLE IN XCE ONLY
 - MINIMUM SPACING FROM CENTER OF OPERATOR TO NEAREST FLAT IS 1 1/8"
 - MINIMUM SPACING BETWEEN 1-14 NPSM OPERATOR CENTERS IS 3/4" FOR THIS ENCLOSURE.
 - MAXIMUM NUMBER OF OPERATORS IS 54.
 - DIMENSION FROM CENTER LINES OF COVER FOR OPERATORS.
 - DIMENSION FROM CENTER LINE AND BACK OF MTG. LOG FOR CONDUIT.
 - FOR MTG. ENCLOSURE USE # BOLT.

		MODIFIED XCE/XHF 243608 ENCLOSURE FOR	
2-13-02 1-0-05 D 10F1	DDH	SEE NOTES TUMBLAST XCE/XHF 243608	XCE/XHF 243608