

OPTIONAL XHF-2 HINGES

EXISTING GRD. SCREW

OPTIONAL MTG. PAN

XCE 2430 COVER

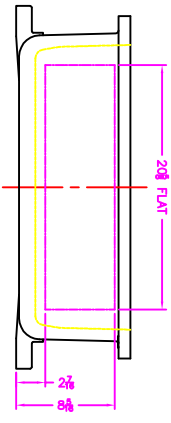

- NOTES:
1. MINIMUM SPACING FROM CENTER OF OPERATOR TO NEAREST FLAT IS 1 1/4".
  2. MINIMUM SPACING BETWEEN #1-14 NPSM OPERATOR CENTERS IS 3/4" FOR THIS ENCLOSURE.
  3. MAXIMUM NUMBER OF OPERATORS IS 42.
  4. DIMENSION FROM CENTER LINE OF COVER FOR OPERATORS.
  5. DIMENSION FROM CENTER LINE AND BACK OF MTG. LUG FOR CONDUIT.
  6. FOR MTG. ENCLOSURE USE # 801T.

		MODIFIED XCE/XUF 243008 ENCLOSURE FOR	
2-13-02 1-5-05 D	DDH	SEE NOTES TUMBLAST XCE/XUF 243008	10F1