

XCE 2424 COVER

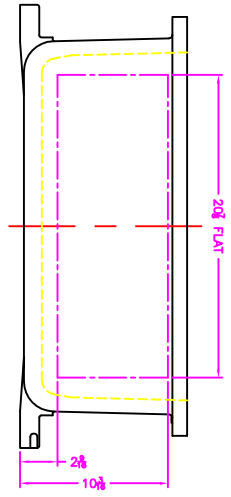

- NOTES:**
1. MINIMUM SPACING FROM CENTER OF OPERATOR TO NEAREST FLAT IS $1\frac{1}{4}$ ALLOWABLE IN XCE ONLY.
 2. MINIMUM SPACING BETWEEN #14 NPSM OPERATOR CENTERS IS $\frac{3}{4}$ FOR THIS ENCLOSURE.
 3. MAXIMUM NUMBER OF OPERATORS IS 36.
 4. DIMENSION FROM CENTER LINE OF COVER FOR OPERATORS.
 5. DIMENSION FROM CENTER LINE AND BACK OF MFG. LUG FOR CONDUIT.
 6. FOR MFG. ENCLOSURE USE # BOLT.

		MODIFIED XCE/XHF 2424+10 ENCLOSURE FOR	
TUMBLAST XCE/XHF 2424+10	DDH 01-08-02 1-4-5 D	10F1	10F1