

OPTIONAL MTG. PAN

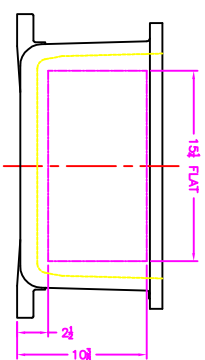

EXISTING GRD. SCREW

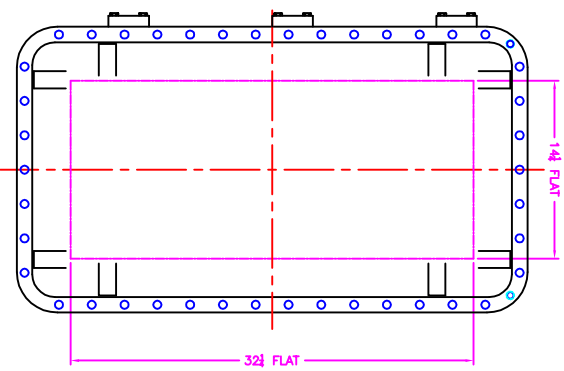
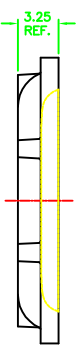
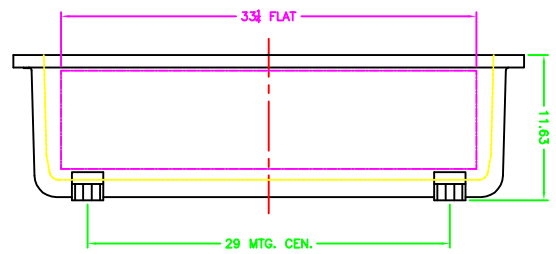

XCE 1836 COVER

- NOTES:
- COVER DRILLING T: MINIMUM SPACING FROM CENTER OF OPERATOR TO NEAREST FLAT IS 1 1/4"
 - ALLOWABLE IN XCE ONLY
 - MINIMUM SPACING BETWEEN 1-1/4" NEMA OPERATOR CENTERS IS 3/4" FOR THIS ENCLOSURE.
 - MINIMUM SPACING BETWEEN 1-1/4" NEMA OPERATOR CENTERS IS 3/4" FOR THIS ENCLOSURE.
 - DIMENSION FROM CENTER LINE AND BACK OF MTG. LUG FOR CONDUIT.
 - FOR MTG. ENCLOSURE USE # BOLT.

TIMBLAST
XCE/XHF 183610

MODIFIED XCE/XHF 183610 ENCLOSURE FOR
 11-16-01
 1-5-28
 D
 10F1