

OPTIONAL XHF-2 HINGES

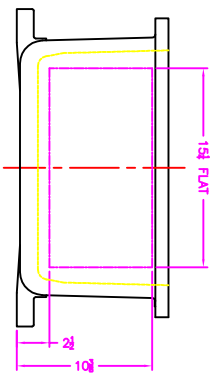

XCE 1824 COVER

- NOTES:
1. MINIMUM SPACING FROM CENTER OF OPERATOR TO NEAREST FLAT IS 1 1/8.
 2. MINIMUM SPACING BETWEEN 3-14 NPSM OPERATOR CENTERS IS 2 1/2 FOR THIS ENCLOSURE.
 3. MAXIMUM NUMBER OF OPERATORS IS 24.
 4. DIMENSION FROM CENTER LINES OF COVER FOR OPERATORS.
 5. DIMENSION FROM CENTER LINES OF BACK OF MFG. LUG FOR CONDUIT.
 6. FOR MFG. ENCLOSURE USE 1/2 BOLT.

		MODIFIED XCE/XUF 1824/10 ENCLOSURE FOR	
DATE: 11-16-01 BY: DDH CHECKED: 1-5 APPROVED: D	TUBELAST XCE/XUF 1824/10	10F1	11-16-01 1-5 D