

OPTIONAL KHC-2 HINGES

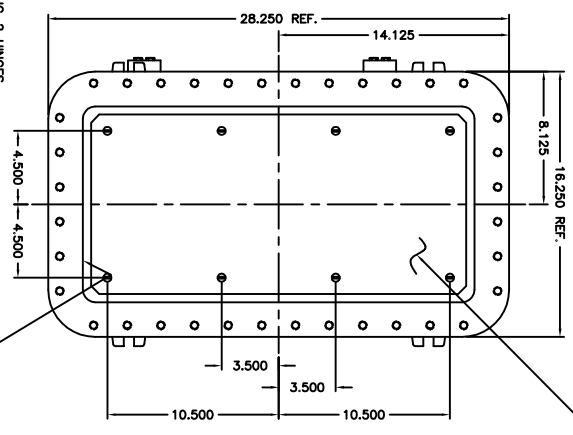

OPTIONAL MTG. PAN

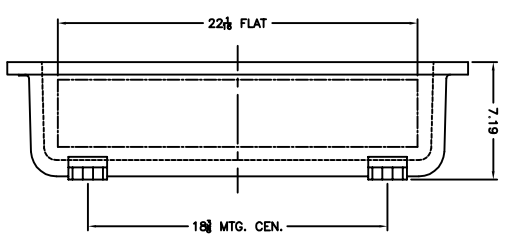

EXISTING GRD. SCREW

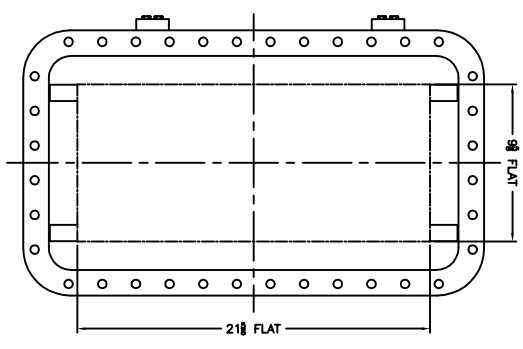

XCE 1224 COVER

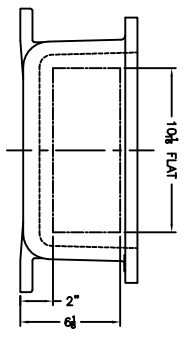

- NOTES:
- COVER DRILLING ALLOWABLE IN XCE ONLY.
 - MINIMUM SPACING FROM CENTER OF OPERATOR TO NEAREST FLAT IS 1 1/4".
 - MINIMUM SPACING BETWEEN #14 NPSM OPERATOR CENTERS IS 3 FOR THIS ENCLOSURE.
 - MAXIMUM NUMBER OF OPERATORS IS 21.
 - DIMENSION FROM CENTER LINES OF COVER FOR OPERATORS.
 - DIMENSION FROM CENTER LINE AND BACK OF MFG. LOG FOR CONDUIT.
 - FOR MTG. ENCLOSURE USE #1 BOLT.

| | | | |
|---|--------------------------|---------------------------------------|-------|
| | | MODIFIED XCE/XUF 122406 ENCLOSURE FOR | |
| DATE: 11-12-01 BY: DDH CHECKED: 1-4-02 APPROVED: D | TUNING XCE/XUF 122406 | DATE: 10F1 | DATE: |