

**XCE 1014 COVER**

**COVER DRILLING ALLOWABLE IN XCE ONLY**

- NOTES:**
1. MINIMUM SPACING FROM CENTER OF OPERATOR TO NEAREST FLAT IS 1 1/8"
  2. MINIMUM SPACING BETWEEN 3/4"-1 1/4" NPSM OPERATOR CENTERS IS 2 1/2" FOR THIS ENCLOSURE.
  3. MAXIMUM NUMBER OF OPERATORS IS 12.
  4. DIMENSION FROM CENTER LINES OF COVER FOR OPERATORS.
  5. DIMENSION FROM CENTER LINE AND BACK OF MTG. LUG FOR CONDUIT.
  6. FOR MTG. ENCLOSURE USE 3/8" BOLT.

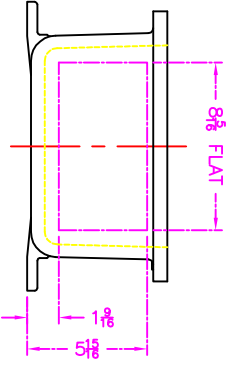

<p>NO NOT SCALE DRAWING DIMENSIONS GOVERN OVER ALL OTHERS CARE MUST BE TAKEN TO VERIFY DIMENSIONS FILED OR CORNER RADIUS 1/8"</p>		<p><b>ADALTEC</b> A SCOTT FETTER COMPANY Manufacturers of Control Cabinets</p>		<p>NOTICE TO PERSON RECEIVING THIS DRAWING: ENCLOSURE IS TO BE MANUFACTURED IN THE UNITED STATES. IN THE EVENT OF ANY DISCREPANCY BETWEEN THIS DRAWING AND THE MANUFACTURER'S DRAWING, THE MANUFACTURER'S DRAWING SHALL PREVAIL. THIS DRAWING IS THE PROPERTY OF ADALTEC AND IS TO BE USED ONLY FOR THE PROJECT AND NOT BE REPRODUCED OR COPIED IN ANY MANNER WITHOUT THE WRITTEN PERMISSION OF ADALTEC.</p>	
DATE	3-16-01	DESIGNED BY	DDH	SCALE	1=5
CHECKED BY		DWG. APPROVAL		DWG. SIZE	C
CAT. NO.	XCE/XJF 101406	DWG. NO.		REV.	10F1
<p>MODIFIED XCE/XJF 101406 ENCLOSURE FOR</p>		<p>DATE</p>			