

EXISTING GRD. SCREW

NOTES:

1. MINIMUM SPACING FROM CENTER OF OPERATOR TO NEAREST FLAT IS 1 1/8".
2. MINIMUM SPACING BETWEEN 1/4"-1 1/4" NPSM OPERATOR CENTERS IS 2 1/2" FOR THIS ENCLOSURE.
3. MAXIMUM NUMBER OF OPERATORS IS 2.
4. DIMENSION FROM CENTER LINES OF COVER FOR OPERATORS.
5. DIMENSION FROM CENTER LINE AND BACK OF MTG. LUG FOR CONDUIT.
6. FOR MTG. ENCLOSURE USE 3/8 BOLT.

XCE 0608 COVER

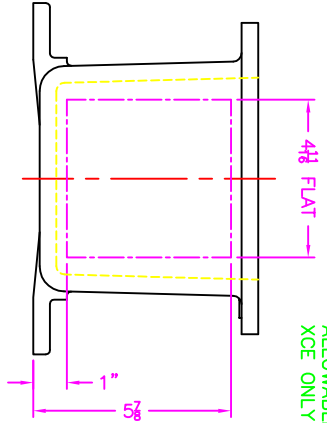

NO HOT SCALE BRANDING DIMENSIONS AND TOLERANCES SPECIFIED UNLESS OTHERWISE INDICATED. DIMENSIONS ON DIMENSIONS UNLESS OTHERWISE SPECIFIED. FILET OR CORNER RADIUS 1/8"		ADALTETT A SCOTT FETTER COMPANY Mechanical Division - Cable Accessories	NOTICE TO PERSON RECEIVING THIS DRAWING: THIS DRAWING IS THE PROPERTY OF ADALTETT. IT IS TO BE USED ONLY FOR THE PROJECT AND SITE SPECIFICALLY IDENTIFIED THEREON. ANY REUSE OF THIS DRAWING FOR OTHER PROJECTS OR SITES WITHOUT THE WRITTEN PERMISSION OF ADALTETT IS STRICTLY PROHIBITED. MATERIAL: TUMBLAST	DESIGNED BY: DDH DATE: 4-20-01
DIMENSIONS FROM TOLERANCED SURFACES UNLESS OTHERWISE SPECIFIED: ANGLES ± 1° FILET RADIUS .03" - .015" R. or .45" ANGLES ± 0° - 30°	MODIFIED XCE/XJF 060806 ENCLOSURE FOR			DRAWN BY: DDH DATE: 4-20-01
CAT NO: XCE/XJF 060806	PART NO: 10F1	DATE: 4-20-01	REV: C	