

SEALING FITTINGS

Sealing Fittings - 25% Fill

FEATURES

- Sealing Fittings are required in Hazardous Locations and are used to isolate arc-producing devices in conduit and wiring systems, and to prevent the passage of explosive pressures from one area to another.
- FOR HORIZONTAL AND VERTICAL MOUNTING - Type XYB and XYBM are suitable for either horizontal or vertical mounting and are provided with threaded plugged openings into which fiber and cement can be placed to form effective seal. XYB has female ends for conduit entrance. The XYBM has female ends with a removable threaded nipple.



XYB-XYBM

FEMALE - FEMALE

Catalog #	Conduit Size (in.)	Oz. Req. for Ea. Sealing Fitting		Std. Package		Male Nipple Cat#
		Sealing Cement	Packing Fiber	Qty.	Weight lbs.	
XYB-2	1/2	1	1/8	5	2.1	3-59
XYB-3	3/4	2	1/4	5	2.6	3-60
XYB-4	1	3	1/4	5	3.7	3-61
XYB-5	1 1/4	6	3/8	2	2.5	3-62
XYB-6	1 1/2	9	1/2	2	3.2	3-63
XYB-8	2	18	3/4	2	5.6	3-64
XYB-10	2 1/2	23	1 1/2	2	6.2	3-65
XYB-12	3	48	3 1/8	1	6.0	3-66
XYB-14	3 1/2	70	4 1/2	1	6.8	3-67
XYB-16	4	90	6	1	8.3	3-68

NOTE Male nipple is not included with the sealing fitting and must be ordered separately. Male nipple will ship loose.

NOMINAL DIMENSIONS [inches]

Conduit Size	A	B	C	D (XYBM)	R (Turn Rad.)
1/2	3 19/32	1 13/16	5/8	1 1/16	1 3/16
3/4	3 25/32	2 1/16	3/4	1 5/16	1 5/16
1	4 3/8	2 5/16	7/8	1 5/16	1 7/16
1 1/4	5 5/32	2 13/16	1 1/16	1 1/16	1 3/4
1 1/2	5 11/16	3 3/16	1 3/16	1 3/16	2
2	6 13/16	3 7/8	1 1/2	1 7/16	2 3/8
2 1/2	7 1/2	4 1/2	1 7/8	1 5/8	2 11/16
3	9 9/16	5 1/2	2 3/16	1 7/8	3 5/16
3 1/2	9 1/2	6 1/8	2 3/8	2	3 11/16
4	9 9/16	6 1/2	2 5/8	2 1/8	3 7/8

*1/2", 3/4", 1" sizes Class I, Group B, C, D, Class II, E, F, G.

1 1/4", 1 1/2", 2", 2 1/2", 3", 3 1/2", 4" sizes Class I, Group C, D; Class II, E, F, G

Certifications



Class I, Groups B*, C & D

Class II, Groups E, F & G

UL Standard 886

CSA Standard C22.2 No. 30

SEALING FITTINGS

Sealing Fittings - 40% Fill

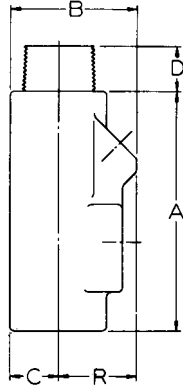

XYB-XYBM

FEATURES

- Sealing Fittings are used for the same application as the standard Adalet sealing fitting but allow up to 40% wire fill in the fitting.

FEMALE - FEMALE

Catalog #	Conduit Size (in.)	Oz. Req. for Ea. Sealing Fitting		Std. Package		Male Nipple Cat#
		Sealing Cement	Packing Fiber	Qty.	Weight lbs.	
XYB-34	1/2	2	1/4	5	2.6	3-59
XYB-44	3/4	3	1/4	5	3.7	3-60
XYB-54	1	6	3/8	2	2.5	3-61
XYB-84	1 1/4	18	3/4	2	5.6	3-62
XYB-104	1 1/2	23	1 1/2	2	6.2	3-63
XYB-124	2	48	3 1/8	1	6.0	3-64
XYB-144	2 1/2	70	4 1/2	1	6.8	3-65
XYB-164	3	90	6	1	8.3	3-66

NOTE Male nipple is not included with the sealing fitting and must be ordered separately. Male nipple will ship loose.

NOMINAL DIMENSIONS [inches]

Conduit Size	A	B	C	D (XYBM)	R (Turn Rad.)
1/2	3 25/32	2 1/16	3/4	15/16	1 5/16
3/4	4 3/8	2 5/16	7/8	15/16	1 7/16
1	5 5/32	2 13/16	1 1/16	1 1/16	1 3/4
1 1/4	6 13/16	3 7/8	1 1/2	1 7/16	2 3/8
1 1/2	7 1/2	4 1/2	1 7/8	1 5/8	2 11/16
2	9 9/16	5 1/2	2 3/16	1 7/8	3 3/16
2 1/2	9 1/2	6 1/16	2 3/8	2	3 11/16
3	9 9/16	6 1/2	2 3/8	2 1/8	3 7/8

*1/2", 3/4" sizes Class I, Group B, C, D, Class II, E, F, G.

1", 1 1/4", 1 1/2", 2", 2 1/2", 3" sizes Class I, Group C, D; Class II, E, F, G

Certifications



Class I, Groups B*, C & D
 Class II, Groups E, F & G
 UL Standard 886
 CSA Standard C22.2 No. 30

EXPLOSIONPROOF
Fittings & Accessories

SEALING FITTINGS

Sealing Fittings - 25% Fill

FEATURES

- Types XY and XYM Fittings: provided with threaded plugged openings into which the sealing cement is poured. Sizes 1-1/4" x 1-1/2" have large plugged openings in the lower hub to facilitate packing fiber around the wires to form a dam. Type XYM's have removable threaded nipples. The two hubs are tapped simultaneously to assure alignment of the conduits, especially important to equipment manufacturers using short runs of conduit.
- FOR HORIZONTAL AND VERTICAL MOUNTING Type XYC Fittings: are for horizontal mounting only, with the cover opening in an upright position. XYCS fittings are for vertical or horizontal mounting, with removable threaded covers which can be turned to the desired Position for pouring in the sealing cement. The covers are interchangeable. The male-to-female types have removable threaded nipple.



XY 2-3-4



XYM 2-3-4



XY 5-6



XYM 5-6



XYC



XYCM



XYCS



XYCSM

Catalog #		Conduit Size	Oz. Req. for Ea. Sealing Fitting		Std. Package	
Fem- Fem	Male - Fem		Sealing Cement	Packing Fiber	Qty.	Weight lbs.
XY2	3-59	1/2	1	1/8	25	10
XY3	3-60	3/4	1	1/4	25	10
XY4	3-61	1	2	1/4	25	12 1/2
XY5	3-62	1 1/4	4	3/8	10	7 1/2
XY6	3-63	1 1/2	5	1/2	10	10
XYC2	3-59	1/2	2	1/8	25	13
XYC3	3-60	3/4	2	1/4	25	13
XYC4	3-61	1	4 1/2	1/4	25	15
XYC5	3-62	1 1/4	8 1/2	3/8	10	10
XYC6	3-63	1 1/2	11 1/2	1/2	10	11
XYC8	3-64	2	13 1/2	3/4	10	12
XYC10	3-59	2 1/2	15	1 1/2	1	2
XYC12	3-66	3	31 1/2	3 1/8	1	3
XYC14	3-67	3 1/2	42 1/2	4 1/2	1	4
XYC16	3-68	4	51	6	1	5
XYC2S	3-59	1/2	2	1/8	25	13
XYC3S	3-60	3/4	2	1/4	25	13
XYC4S	3-61	1	3	1/4	25	15
XYC5S	3-62	1 1/4	6 1/2	3/8	10	10
XYC6S	3-63	1 1/2	10	1/2	10	11
XYC8S	3-64	2	12 1/2	3/4	10	12
XYC10S	3-59	2 1/2	13 1/2	1 1/2	1	2
XYC12S	3-66	3	29 1/2	3 1/8	1	3
XYC14S	3-67	3 1/2	40	4 1/2	1	4
XYC16S	3-68	4	48 1/2	6	1	5

Certifications

Class I, Group D
 Class II, Groups E, F & G
 UL Standard 886
 CSA Standard C22.2 No. 30



SEALING FITTINGS

Sealing Fittings - 40% Fill



XY 34, 44



XYM 34, 44



XY 54



XYM 54



XYC 34-164

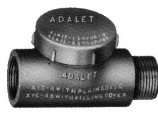

XYC 34M-164M



XYC 34S-164S



XYC 34SM-164SM

FEATURES

- Adalet 40% Fill Sealing Fittings are used for the same applications as the standard Adalet Sealing Fittings, but allow up to 40% wire fill in the fitting.

Catalog #		Conduit Size	Oz. Req. for Ea. Sealing Fitting		Std. Package	
Fem - Fem	Male - Fem		Sealing Cement	Packing Fiber	Qty.	Weight lbs.
XY34	3-59	1/2	1	1/4	25	10
XY44	3-60	3/4	2	1/4	25	12 1/2
XY54	3-61	1	4	3/8	10	7 1/2
XYC34	3-59	1/2	2	1/4	25	13
XYC44	3-60	3/4	4 1/2	1/4	25	15
XYC54	3-61	1	8 1/2	3/8	10	10
XYC84	3-62	1 1/4	13 1/2	3/4	10	12
XYC104	3-63	1 1/2	15	1 1/2	1	2
XYC124	3-64	2	31 1/2	3 3/8	1	3
XYC144	3-65	2 1/2	42 1/2	4 1/2	1	4
XYC164	3-66	3	51	6	1	5
XYC34S	3-59	1/2	2	1/4	25	13
XYC44S	3-60	3/4	3	1/4	25	15
XYC54S	3-61	1	6 1/2	3/8	10	10
XYC84S	3-62	1 1/4	12 1/2	3/4	10	12
XYC104S	3-63	1 1/2	13 1/2	1 1/2	1	2
XYC124S	3-64	2	29 1/2	3 3/8	1	3
XYC144S	3-65	2 1/2	40	4 1/2	1	4
XYC164S	3-66	3	48 1/2	6	1	5

Certifications

Class I, Groups B*, C & D
 Class II, Groups E, F & G
 UL Standard 886
 CSA Standard C22.2 No. 30



SEALING FITTINGS

Sealing Fittings - 25% Fill

Catalog #		Conduit Size	Nominal Dimensions					R=Turning Radius Cover		
Fem - Fem	Male - Fem		A	B	C	D	E	Plain	Sealing	None
XY2	3-59	1/2	3 1/16	2 7/16	3/4	1 1/16				1 13/16
XY3	3-60	3/4	3 1/16	2 7/16	3/4	1				1 13/16
XY4	3-61	1	3 3/4	2 15/16	15/16	15/16				2 1/8
XY5	3-62	1 1/4	4 15/16	3 3/16	1 3/16	1 1/8				2 1/8
XY6	3-63	1 1/2	4 7/8	3 7/16	1 5/16	1 5/16				2 1/4
XYC2	3-59	1/2	3 1/16	2 9/16	2 1/16	5/8	13/16	1 7/8		
XYC2S	3-59	1/2	3 1/16	2 9/16	2 1/16	5/8	13/16		2 11/16	
XYC3	3-60	3/4	3 1/16	2 9/16	2 1/16	15/16	13/16	1 7/8		
XYC3S	3-60	3/4	3 1/16	2 9/16	2 1/16	15/16	13/16		2 11/16	
XYC4	3-61	1	3 11/16	2 11/16	2 3/8	15/16	1	2 1/8		
XYC4S	3-61	1	4 1/2	3 3/16	3 3/8	1 1/16	7/8		3 1/16	
XYC5	3-62	1 1/4	4 1/2	3 3/16	3 3/8	1 1/16	7/8	2 11/16		
XYC5S	3-62	1 1/4	4 1/2	3 3/16	3 3/8	1 1/16	7/8		3 1/16	
XYC6	3-63	1 1/2	4 1/2	3 7/16	3 3/8	1 1/8	7/8	2 11/16		
XYC6S	3-63	1 1/2	4 1/2	3 7/16	3 3/8	1 1/8	7/8		3 1/16	
XYC8	3-64	2	4 11/16	4	3 3/8	1 3/8	7/8	3		
XYC8S	3-64	2	4 11/16	4	3 3/8	1 3/8	7/8		3 5/16	
XYC10	3-59	2 1/2	5 5/16	4 5/8	3 3/8	1 5/8	7/8	3 1/4		
XYC10S	3-59	2 1/2	5 5/16	4 5/8	3 3/8	1 5/8	7/8		3 3/4	
XYC12	3-66	3	6 7/16	5 7/16	3 15/16	1 3/4	1 3/8	4		
XYC12S	3-66	3	6 7/16	5 7/16	3 15/16	1 3/4	1 3/8		4 5/8	
XYC14	3-67	3 1/2	6 9/16	6 3/8	4 3/4	1 5/8	1 5/16	4 5/8		
XYC14S	3-67	3 1/2	6 9/16	6 3/8	4 3/4	1 5/8	1 5/16		5	
XYC16	3-68	4	6 15/16	6 13/16	4 3/4	2	1 5/16	4 3/4		
XYC16S	3-68	4	6 15/16	6 13/16	4 3/4	2	1 5/16		5 3/8	

XYM

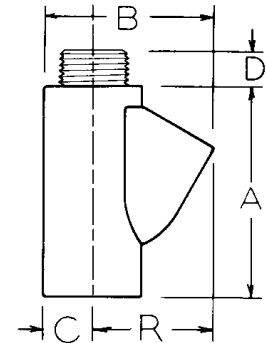

XYCSM

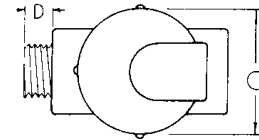

XYCS

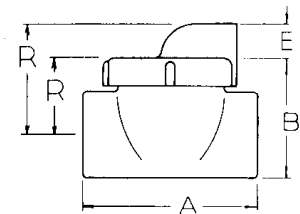

Certifications

CSA Certified LR27991
UL Listed E10493



SEALING FITTINGS

Sealing Fittings - 40% Fill

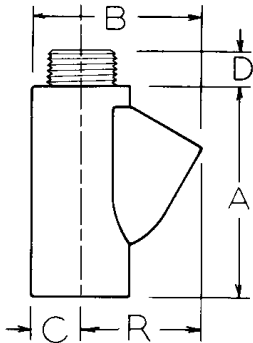

XYM

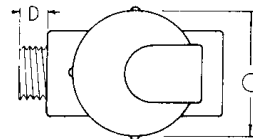

XYGSM

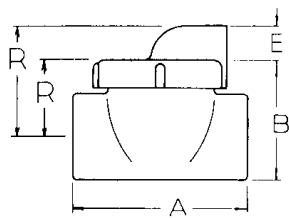

XYGS

Catalog #		Conduit Size	Nominal Dimensions					R=Turning Radius Cover		
Fem-Fem	Male-Fem		A	B	C	D	E	Plain	Sealing	None
XY34	3-59	1/2	3 1/8	2 7/16	3/4	1				1 13/16
XY44	3-60	3/4	3 3/4	2 15/16	15/16	1 1/8				3 1/8
XY54	3-61	1	4 15/16	3 3/8	1 3/8	1 1/8				2 1/8
XYC34	3-59	1/2	3 1/8	2 9/16	2 1/8	15/16	13/16	1 7/8		
XYC34S	3-59	1/2	3 1/8	2 9/16	2 1/8	15/16	13/16		2 11/16	
XYC44	3-60	3/4	3 11/16	2 11/16	2 3/8	15/16	1	2 1/8		
XYC44S	3-60	3/4	3 11/16	2 11/16	2 3/8	15/16	1		3 1/8	
XYC54	3-61	1	4 1/2	3 3/8	3 3/8	1 1/8	7/8	2 11/16		
XYC54S	3-61	1	4 1/2	3 3/8	3 3/8	1 1/8	7/8		3 1/8	
XYC84	3-62	1 1/4	4 11/16	4	3 3/8	1 3/8	7/8	3		
XYC84S	3-62	1 1/4	4 11/16	4	3 3/8	1 3/8	7/8		3 5/8	
XYC104	3-63	1 1/2	5 5/16	4 5/8	3 3/8	1 5/8	7/8	3 1/4		
XYC104S	3-63	1 1/2	5 5/16	4 5/8	3 3/8	1 5/8	7/8		3 3/4	
XYC124	3-64	2	6 7/16	5 7/16	3 15/16	1 3/4	1 3/8	4		
XYC124S	3-64	2	6 7/16	5 7/16	3 15/16	1 3/4	1 3/8		4 5/8	
XYC144	3-65	2 1/2	6 9/16	6 3/8	4 3/4	1 5/8	1 5/16	4 5/8		
XYC144S	3-65	2 1/2	6 9/16	6 3/8	4 3/4	1 5/8	1 5/16		5	
XYC164	3-66	3	6 15/16	6 13/16	4 3/4	2	1 5/16	4 3/4		
XYC164S	3-66	3	6 15/16	6 13/16	4 3/4	2	1 5/16		5 3/8	

Certifications

CSA Certified LR27991
UL Listed E10493



EXPLOSIONPROOF
Fittings & Accessories